

**Instructions for Use**  
**Wire Guides with Extension**

---

1. Insert the wire passer around the bone (all shown below).



2. Insert the auxiliary tool.

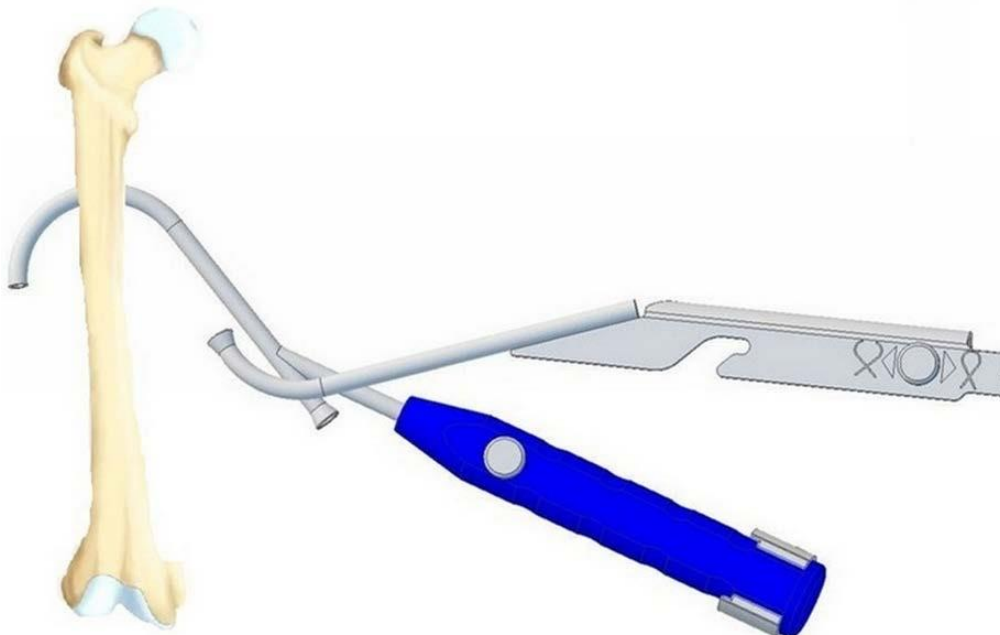

**Instructions for Use**  
**Wire Guides with Extension**

---

**3. Combine and close both components.**

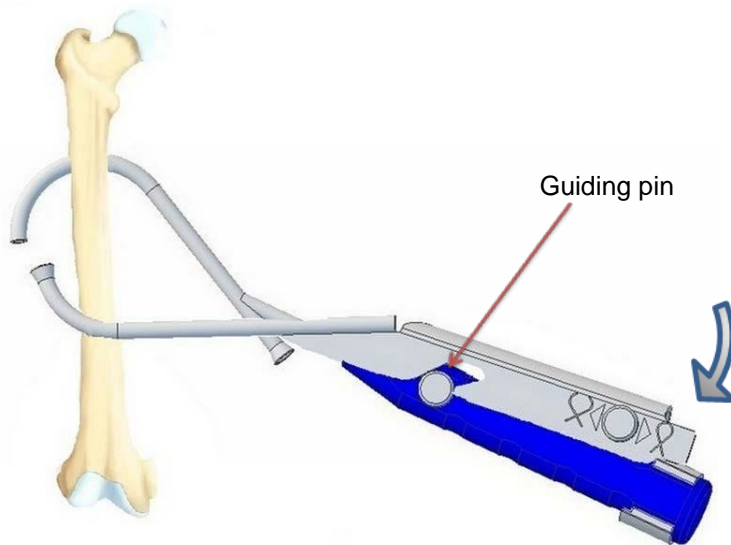

- Put the notch of the auxiliary tool over the guiding pin and gently slide the components together.
- Align the handle and the auxiliary tool. During the process, the auxiliary tool slides in the notch.

**4. Check the correct position once connected.**

- Align the auxiliary tool until it reaches the end of the notch.

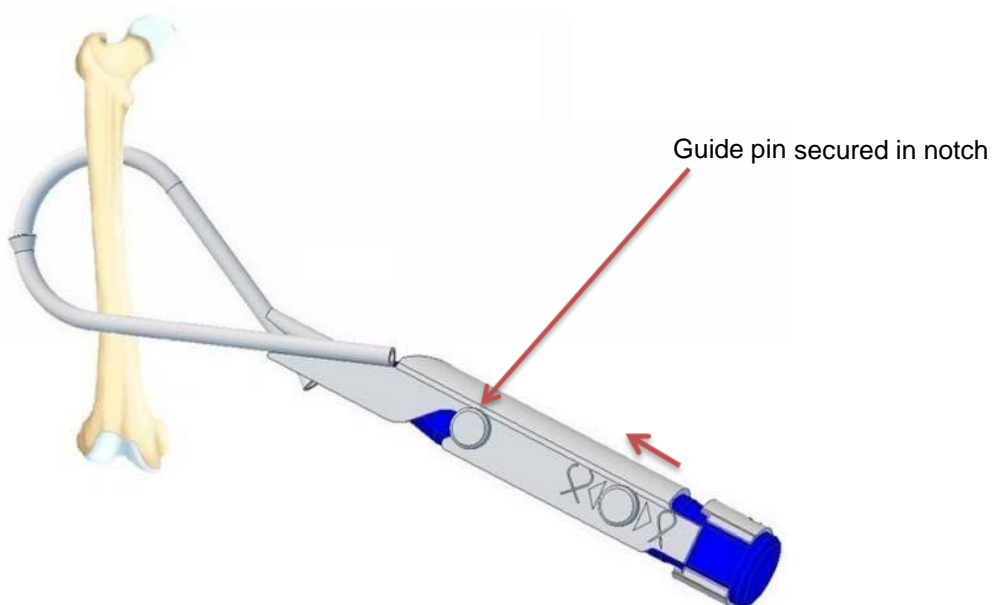

**Instructions for Use**  
**Wire Guides with Extension**

---

**5. Lock the components by turning the safety ring.**

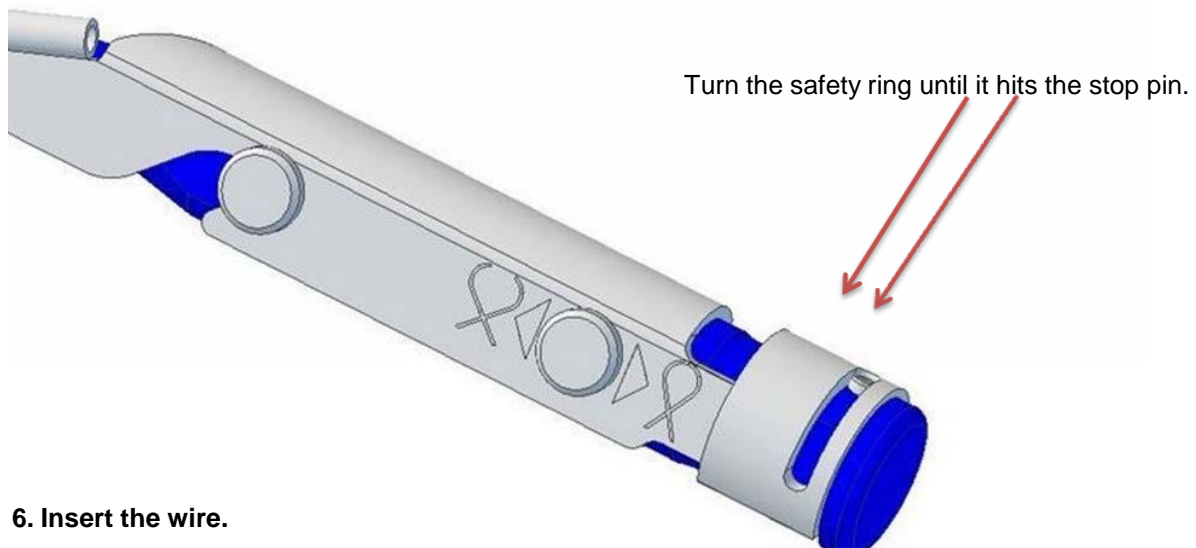

**6. Insert the wire.**

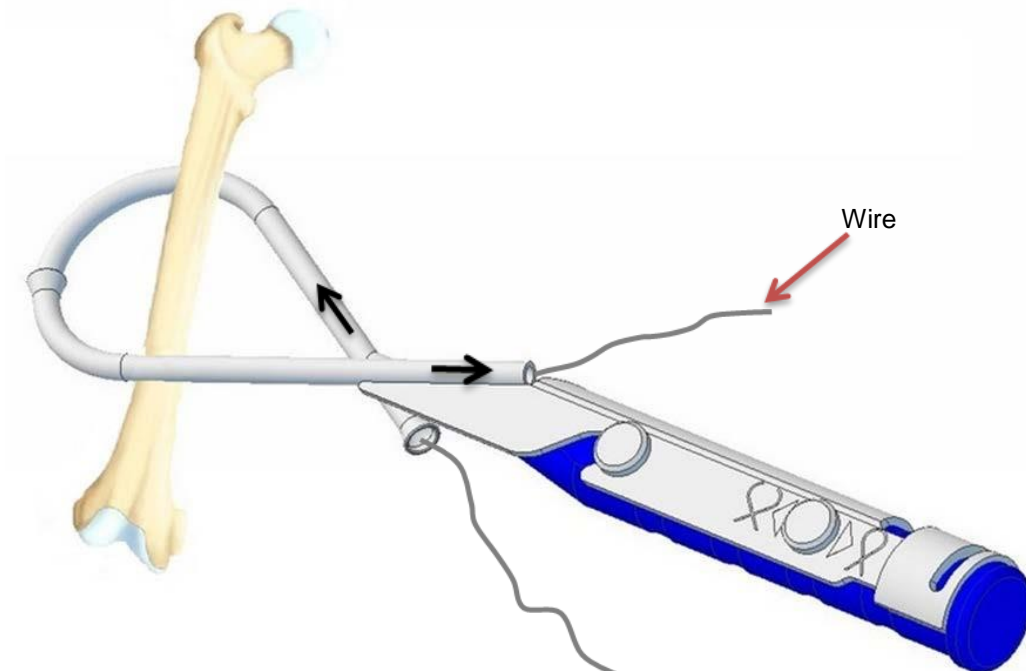

- Insert the wire in the direction indicated by above black arrows.
- Disassembly occurs in reverse order. Make sure that the wire does not retract during the process.

**Instructions for Use**  
**Wire Guides with Extension**

---

Artemamed, LLC does not accept any liability if these instructions for use have not been observed or followed.

Replacement parts can be obtained from Artemamed:

Artemamed 82.5245 Wire Guide with Extension 11" Ø 45mm, plastic handle, blue

Artemamed 82.5250 Wire Guide with Extension 11 ½" Ø 70mm, plastic handle, blue

EC REP



MD

LOT

REF

7901 4th St. N  
STE  
10963, Saint  
Petersburg,  
Florida, 33702

**Email:**

[sales@artemamedical.com](mailto:sales@artemamedical.com)

**Website:**

[www.artemamed.com](http://www.artemamed.com)